

FLEXI-HEX[®]

→ **Data sheet – Double Fold Top Box**

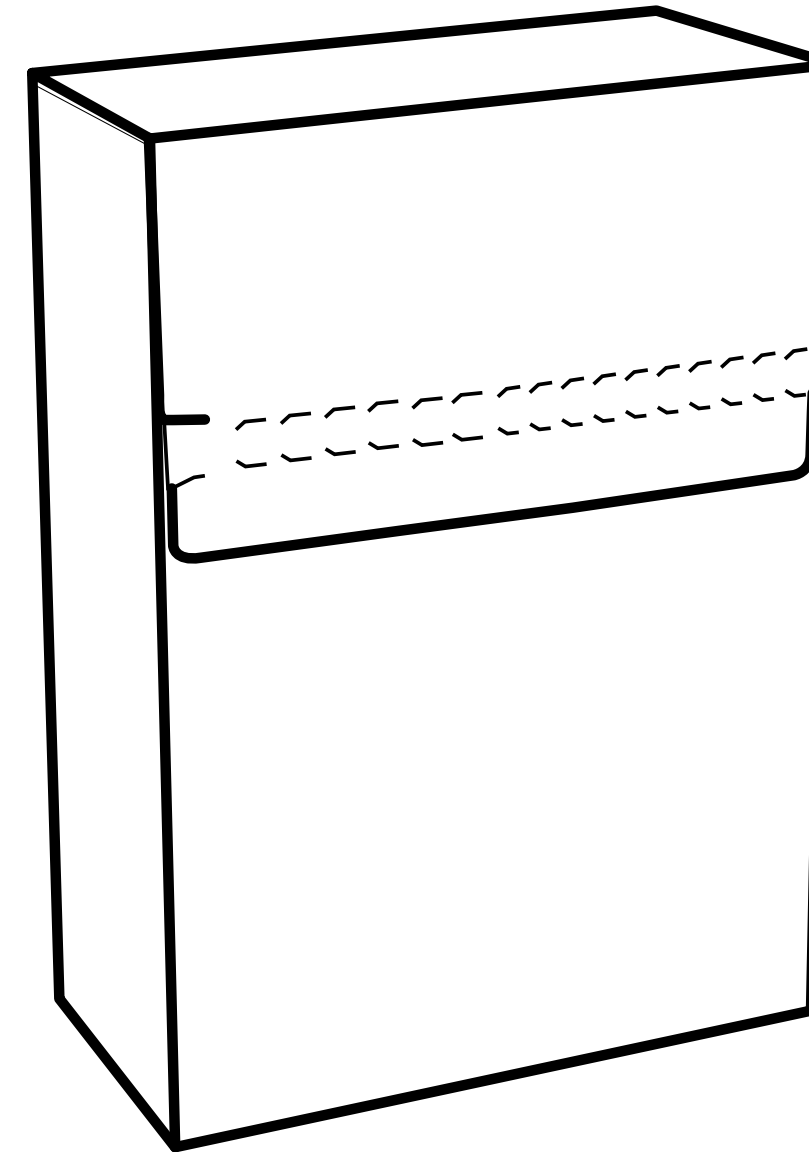

Overview

A square-shaped box for shipping two bottles. We recommend using the Flexi-Hex Mini Sleeve for naked bottles and the Flexi-Hex Air 35cm Sleeve for pre-boxed bottles.

Details

- Designed for the safe shipping of two bottles
- Fits bottles of all shapes and sizes up to a maximum of 350mm in height, including pre-boxed bottles
- Made from high-quality paper
- 100% plastic-free, kerbside recyclable, home compostable and biodegradable
- Self-sealing with crash-lock base so no tape required
- Separate layer pad which slots into bottom of box for extra protection
- Unique fold which tucks over bottles to prevent movement within the box and can be adjusted to fit wider bottles and pre-boxed bottles
- Tear strip for easy opening
- Prevents movement and reduces breakage rates through innovative engineering
- Compact to store and lightweight for cost-effective shipping and storage
- Can be customised with company branding
- An aesthetic e-commerce solution which adds brand value and improves the customer unboxing experience
- Also available in single, triple, four and six box sizes

Product Information

NAME

Flexi-Hex® Double Fold Top Box

SKU

FOL-BOX-002

Specification

	WEIGHT	QTY PER BOX
BOX DIMENSIONS		
362mm H x 251mm W x 125mm D	283g	
MINI SLEEVE UNIT (2X)		
330mm L x 35mm W x 15mm H	135g SU	100pcs
35CM AIR SLEEVE UNIT (1X)		
350mm L x 25mm W x 12mm H	60g	600pcs
BUNDLE QTY	TBC	

Material



Sleeve: Recycled cardboard recyclable and biodegradable 85% recycled content
Box: B-Flute

DATA SHEET - DOUBLE FOLD TOP

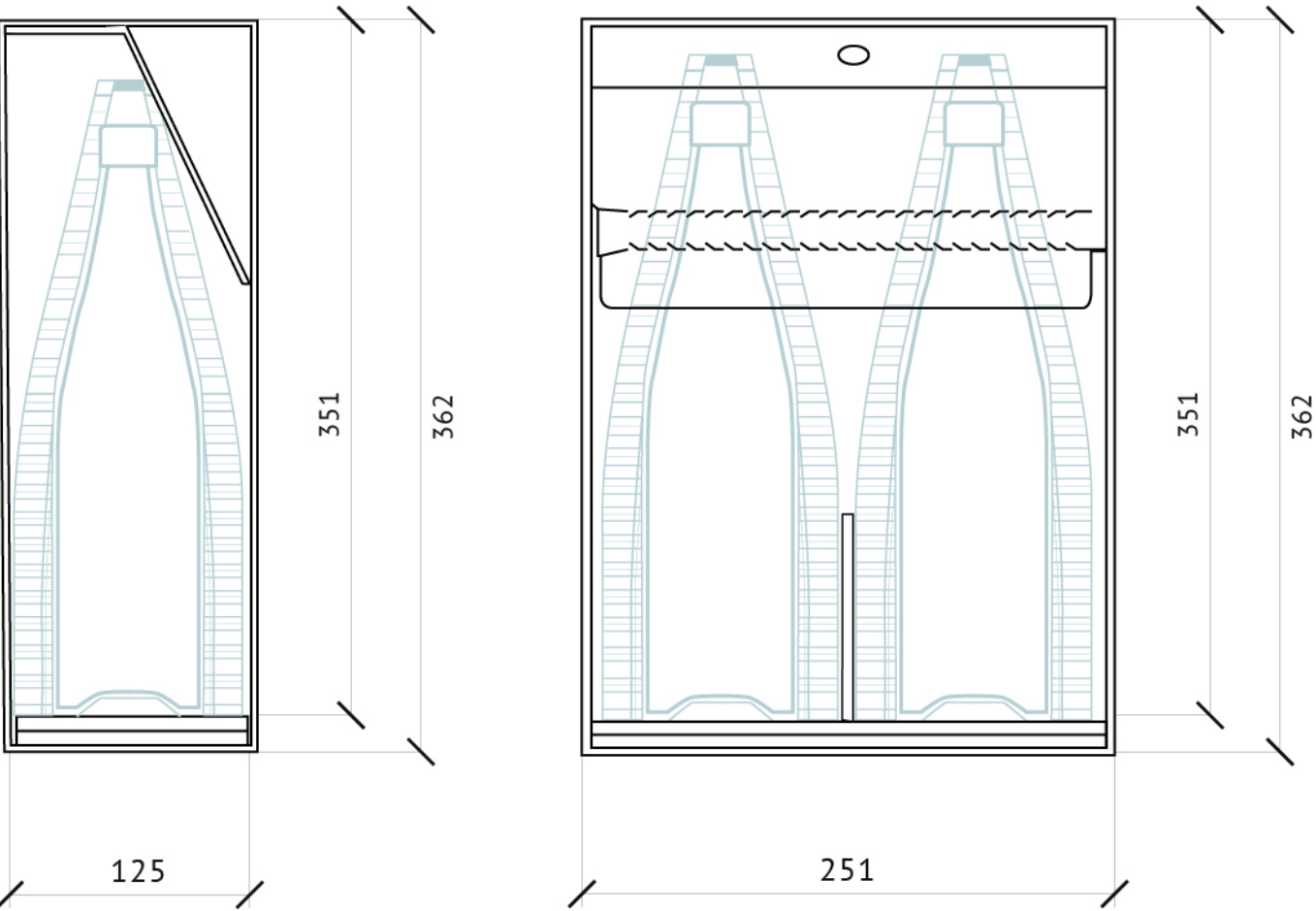
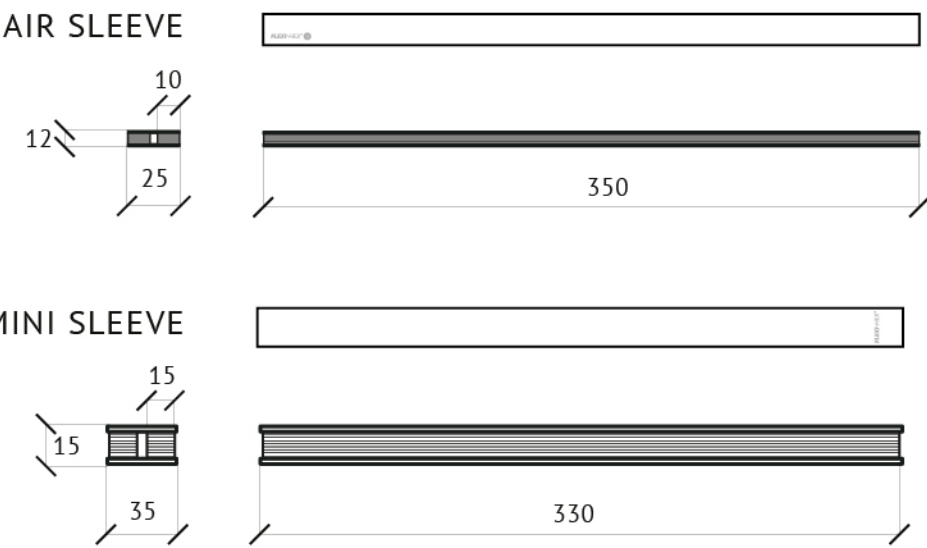
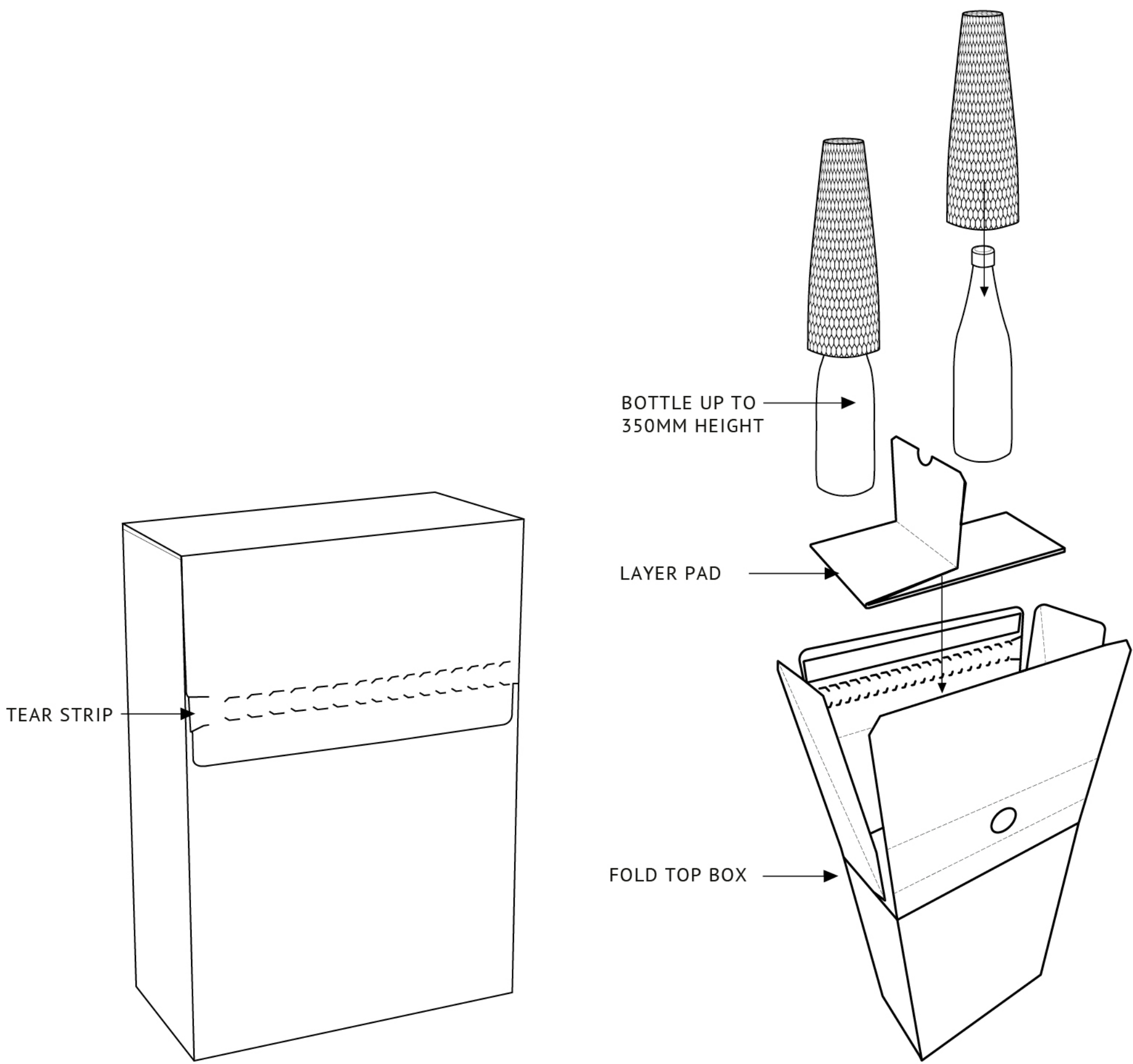

DATA SHEET - DOUBLE FOLD TOP

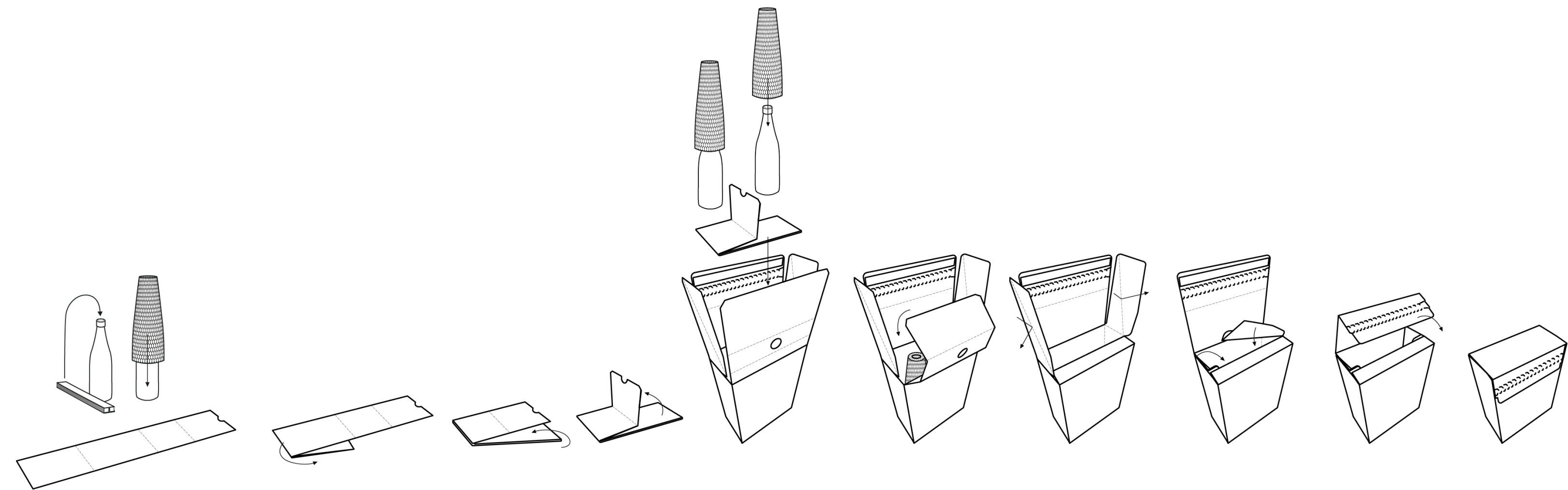

Flexi-Hex Mini Sleeve

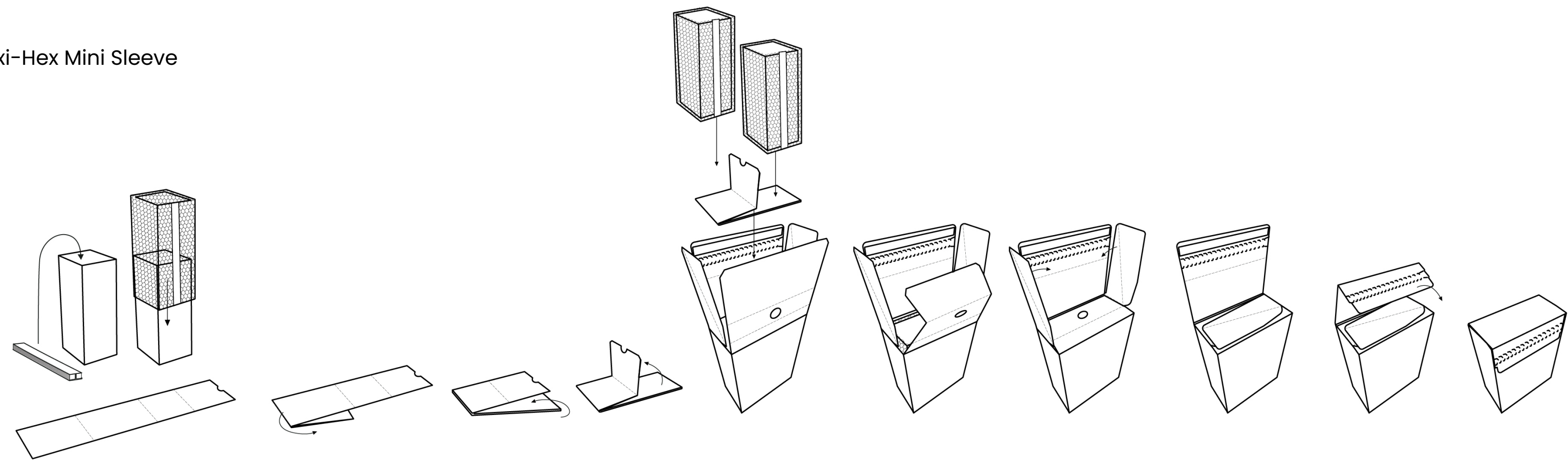

Flexi-Hex Air Sleeve

DATA SHEET - DOUBLE FOLD TOP

