

***FLEXI-HEX***<sup>®</sup>

→ **Data sheet - Double Pinch Top Box**

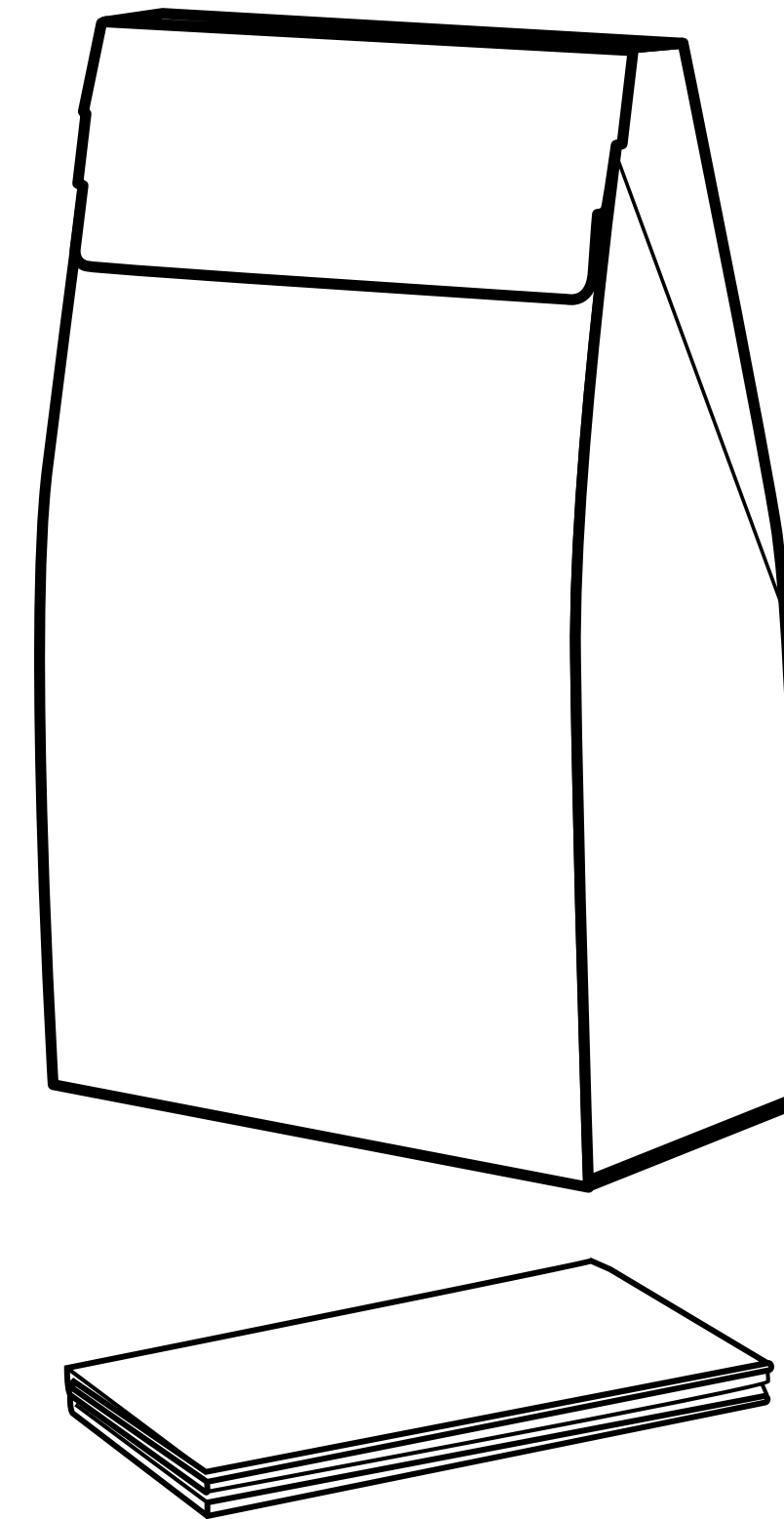

## Overview

A self-sealing pinch top box to be used in combination with the Flexi-Hex Mini® Sleeve for safely shipping bottles or other fragile products.

## Details

- Designed for the safe shipping of bottles and other fragile products
- Fits a range of products up to a maximum of 320mm in height
- Made from high-quality paper
- 100% plastic-free, kerbside recyclable, home compostable and biodegradable
- Self-sealing with crash-lock base so no tape required
- Includes a tear-off layer pad base for extra protection
- Tear strip for easy opening
- Prevents movement and reduces breakage rates through innovative engineering
- Compact to store and lightweight for cost-effective shipping and storage
- Can be customised with company branding
- An aesthetic e-commerce solution which adds brand value and improves the customer unboxing experience
- Also available in single & triple sizes

## Product Information

### NAME

Flexi-Hex® Double Pinch Top Box

### SKU

PIN-BOX-002CL

## Specification

	WEIGHT	QTY
<b>BOX DIMENSIONS</b>		
380mm H x 245mm W x 125mm D	193.5g	
<b>SLEEVE UNIT (2X)</b>		
330mm x 35mm W x 15mm H	135g x2	100pcs
<b>COMPLETE UNIT</b>		
380mm H x 245mm W x 125mm D	464.5g	
<b>BOX BUNDLE</b>		
610 x 362 x 180mm	3.9kg	20pcs

## Pallet info

### DIMENSIONS

1220 x 1000 x 1200mm\*

### WEIGHT

141Kg\*

### QTY

600\*

## Performance

### CRUSH TEST (SLEEVE)

Test follows procedure outlined DIN EN 23035, 09/1994  
 At 23°C, 50% RH collapsing of the cells was on average 229kPa.  
 At 40°C, 90% RH collapsing of the cells was on average 147kPa.

## Material

Sleeve: Recycled cardboard recyclable and biodegradable  
 85% recycled content  
 Box: 150KK/150FF/150TT B-Flute



\*pallet dimensions, weight and qty may vary depending on supplier

**DATA SHEET - DOUBLE PINCH TOP BOX**

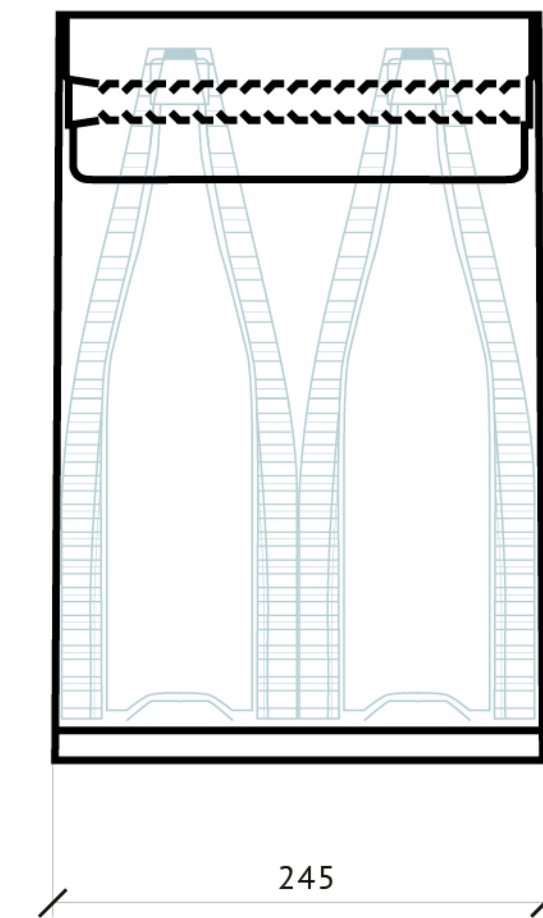
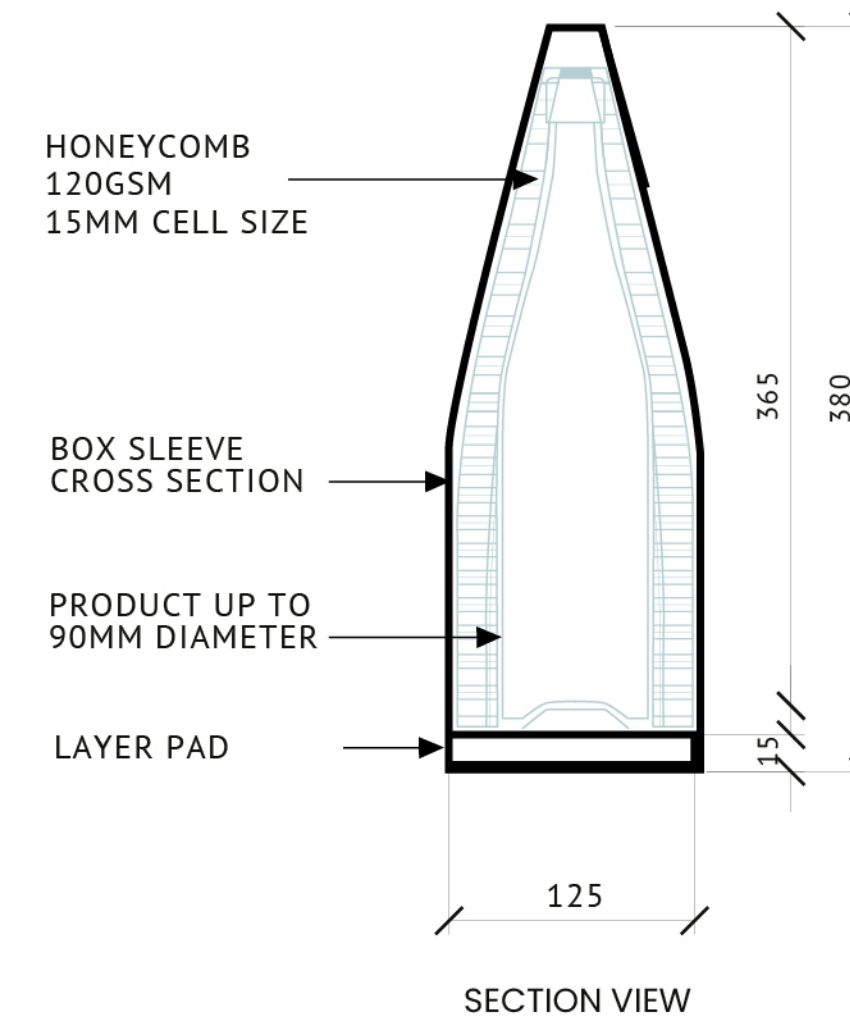
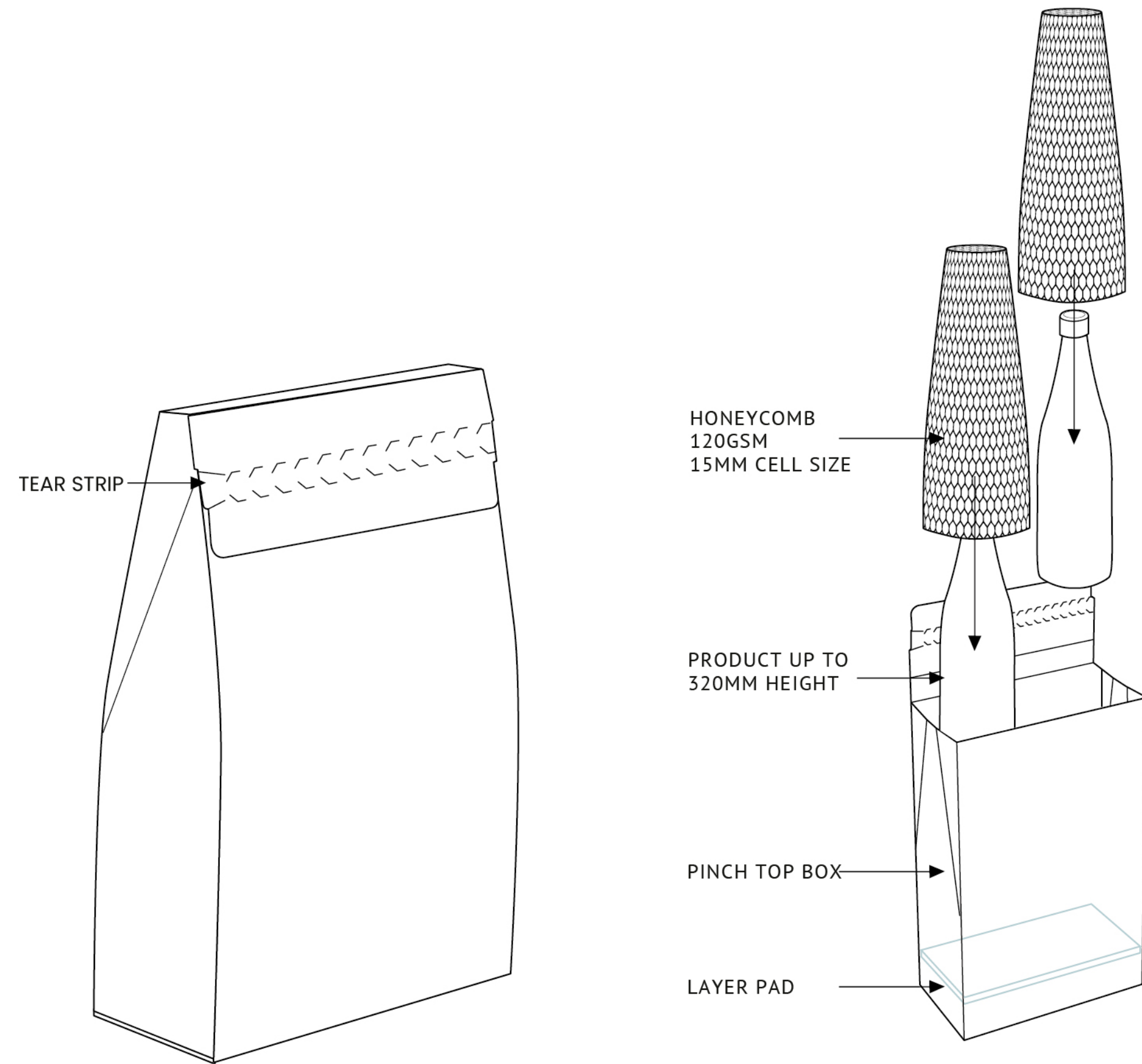

DESIGN PATENT: GB2564066  
COPYRIGHT © 2019 Flexi-Hex Ltd.  
ALL RIGHTS RESERVED

**DATA SHEET - DOUBLE PINCH TOP BOX**

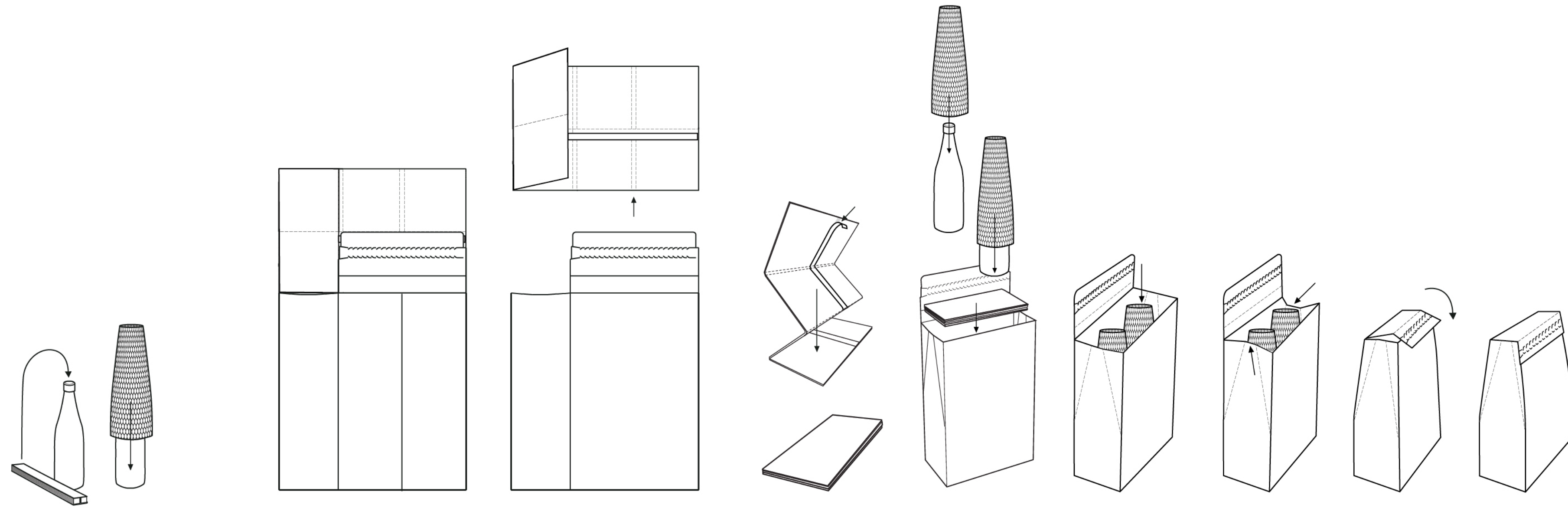

DATA SHEET - DOUBLE PINCH TOP BOX

